

LAZY DAWG CUSTOMS Ltd

Peg Cover w/Filler Installation

TOOLS/SUPPLIES REQUIRED

5/64" Hex Wrench (Allen Wrench)
Utility/Razor Knife

Loctite (thread locker)
(2) 8-32 x 1/4" Stainless Setscrews
(supplied)

1 Aluminum Filler Piece (supplied)

- 1) Place a drop of Loctite on each of the 8-32 x 1/4" stainless steel setscrews
- 2) Thread each setscrew into a threaded hole at the open end of the Peg Cover. (Note: *Do not thread setscrews in too far at this time, you will need to be able to slip Peg Cover over end of OEM Peg*)
- 3) Remove OEM Rubber Boot from the Peg. Using a utility knife or razor blade is the easiest way. Please be careful when using sharp tools.(See Picture 1)



- 4) Place the Filler Piece onto the underside of Peg with the "Step" facing towards the Shift Bar, temporarily hold in place with a piece of tape. (see Pictures 2 & 3)

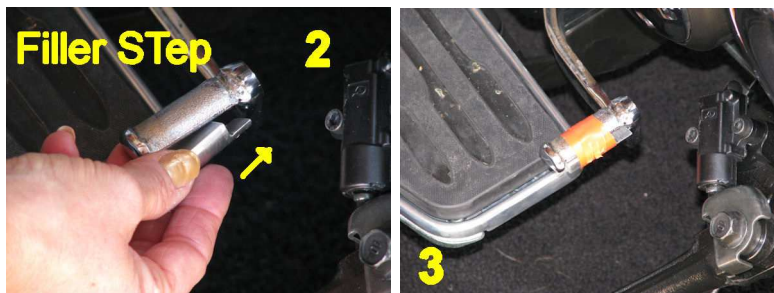

LAZY DAWG CUSTOMS Ltd

- 5) Slide Peg Cover over the OEM Peg and Filler up against factory weld joint. (See Picture 4)



- 6) Rotate Peg so that setscrews are oriented “Up” and thread in until they just touch the peg then back off slightly (This will save time and effort while easy to reach)
- 7) Next rotate Peg so that setscrews are oriented to the bottom to hide from view
- 8) While holding the peg cover up against factory weld joint, use 5/64” Hex wrench to evenly tighten the (2) setscrews. The setscrews should tighten onto the Filler Step. (***DO NOT OVERTIGHTEN, A MAXIMUM OF 10 INCH/LBS TORQUE***)
- 9) Let Loctite fully cure before using Peg Cover

Some installations may require that the Shifter Position be adjusted

If you have questions or problems please email me at:

jc@lazydawgcustoms.com